

HWV Series

Submersible Pumps | Vortex Submersibles



Application

- Heavy duty wastewater and drainage pumps for municipal applications
- Suited to domestic, commercial and industrial applications containing soft or fibrous solids
- Pump solids up to 70% of discharge size

Features

- Semi-open Vortex Impeller design, for non-clog operations
- Heavy duty HT200 cast iron construction
- Stainless steel shaft
- Guide rail kits available for all models
- Thermal overload protection

Working Conditions

- Liquid Temperature: 0 – 40°C (32 – 104°F)
- Max Immersion Depth: 5m

Technical Data

Model	Power kW (HP)	Discharge mm (inch)	Phase	Rated Flow (m ³ /h)	Rated Head	Solid Passage (mm)
HWV50-037-1A	0.37 (1/2)	50 (2")	1	9	6	35
HWV50-075-1	0.75 (1)	50 (2")	1	12	8	35
HWV50-075-1A	0.75 (1)	50 (2")	1	12	8	35
HWV65-15-1	1.5 (2)	65 (2.5")	1	24	8.5	50
HWV65-15-3	1.5 (2)	65 (2.5")	3	24	8.5	50
HWV65-22-1	2.2 (3)	65 (2.5")	1	24	12.5	50
HWV65-22-3	2.2 (3)	65 (2.5")	3	24	12.5	50
HWV65-40-3	4 (5.5)	65 (2.5")	3	30	16	55

HWV50 / HWV65 Vortex Pumps



Motor

- Frequency/Pole number: 50Hz/2
- Insulation Class: F
- Protection Class: IPX8
- Heavy Duty Ball Bearings
- Double silicon/carbon mechanical seals

Performance

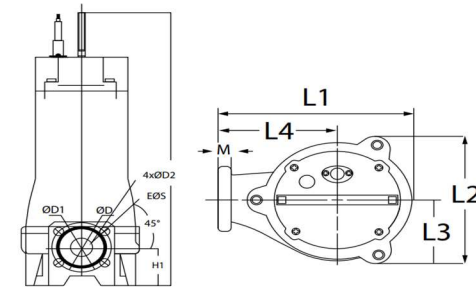
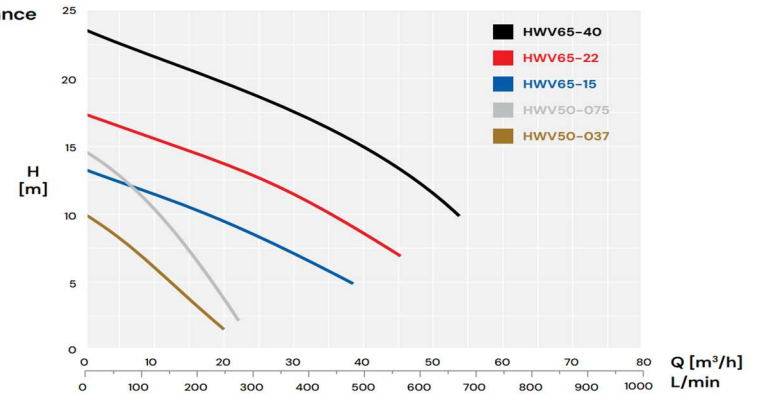

Dimensions

Model	Phase	Ø	L1	L2	L3	L4	H	H1	D	D1	D2	M
HWV50-037-1A	1	230	178	89	121	560	75	50	110	14	16	16
HWV50-075-1	1	230	178	89	121	560	75	50	110	14	16	16
HWV50-075-1A	1	230	178	89	121	560	75	50	110	14	16	16
HWV65-15-1	1	268	219	111	161	667	93	65	130	14	16	16
HWV65-15-3	3	268	219	111	161	626	93	65	130	14	16	16
HWV65-22-1	1	268	219	111	161	667	93	65	130	14	16	16
HWV65-22-3	3	268	219	111	161	626	93	65	130	14	16	16
HWV65-40-3	3	260	218	118	149	806	122	80	150	18	18	18

Commercial Plumbing & Fire Supplies

Site Address

6A Kelly Court,
Springvale, VIC 3171

Postal Address

6A Kelly Court,
Springvale, VIC 3171

Contact Details

P: 03 9791 7500
E: sale@cpfs.net.au

